

# LED VERSA LIGHT™ MODEL 485-115V-36

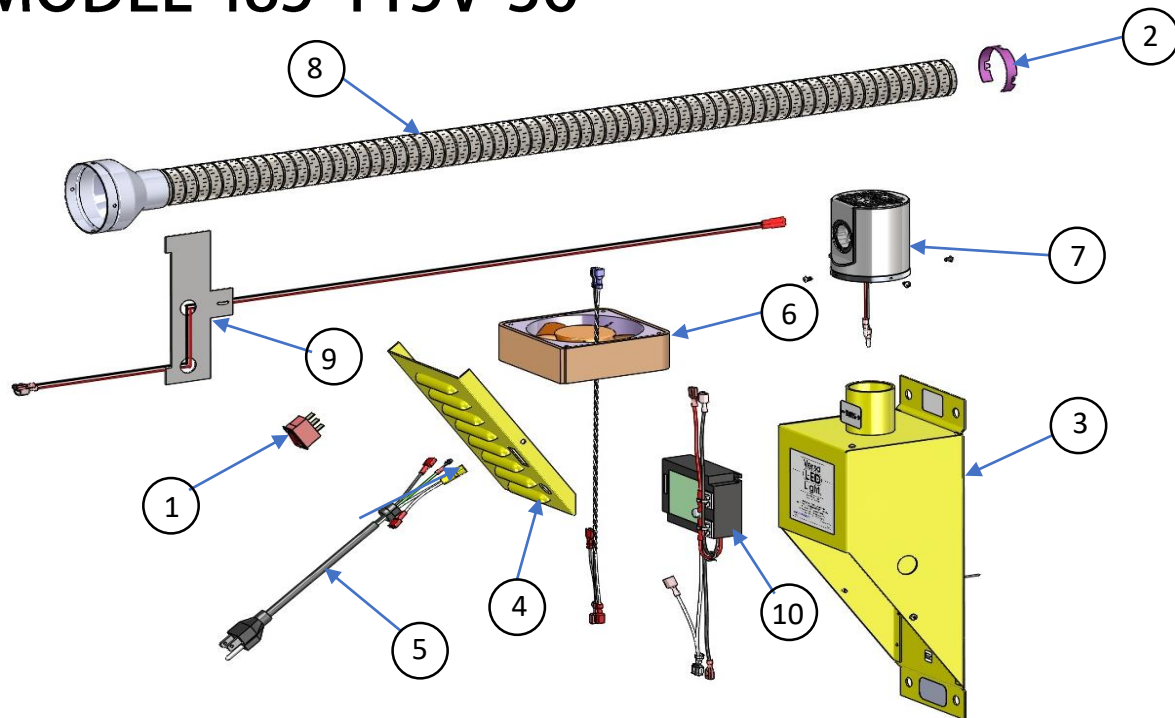

## ELECTRICAL SCHEMATIC SCHÉMA ÉLECTRIQUE

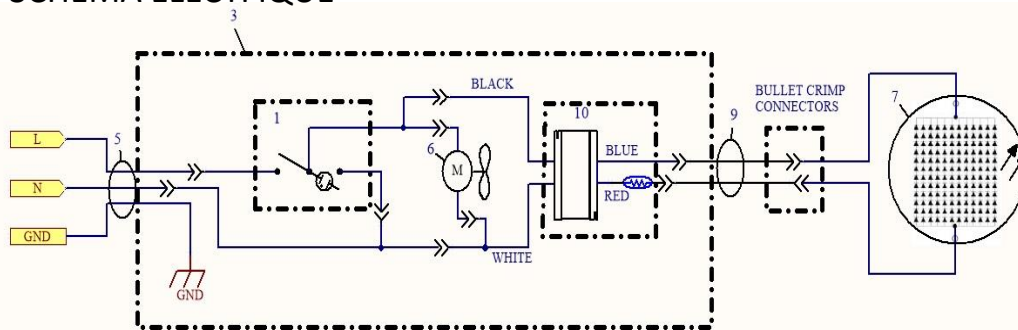

ITEM NO.	PART NUMBER	DESCRIPTION	QTY.
1	VL2003	115 VAC SWITCH	1
2	VL4001	TUBE SPRING	1
3	VL5001	VERSA LIGHT CABINET	1
4	VL5003	COVER PLATE	1
5	VL5008	POWER CORD 300V, 4FT.	1
6	VL5053	115V LED FAN ASM	1
7	VL5104	485 BULB HEAD ASSEMBLY	1
8	VL5111	36" FLEX TUBE KIT FOR THE VL-485	1
9	VL5112	36" WIRING HARNESS & AIR DEFLECTOR KIT	1
10	VL8085	WIRING LED DRIVER	1

# Versa Light® Installation Guide

MODEL 485-115V-36

Guide d'Installation

## Mounting Instructions/Documentation pour Monter

### Important!

**HARD WIRE APPLICATIONS  
MUST BE INSTALLED BY  
QUALIFIED ELECTRICIAN**

115VAC, 0.46 AMPS, 50/60HZ  
VOLTAGE

For proper operation LED  
Versa Light must be mounted  
at least 66" from floor (see  
figure).

Contact manufacturer for  
alternate mounting procedures.

(4) installer supplied wall  
fasteners are required.

### Important!

**DOIVENT ÊTRE INSTALLÉS  
PAR ÉLECTRICIEN  
QUALIFIÉ**

Tous voltages en plus de 120  
VAC

Tous modèles

Pour fonctionnement correct, il  
faut monter LED Versa Light au  
moins 168 cm du plancher  
(Voyez l'illustration)

Contactez le fabricant pour les  
procédures alternatives de  
montage.

4 attaches-mur  
approvisionnées par  
l'installateur sont obligatoires

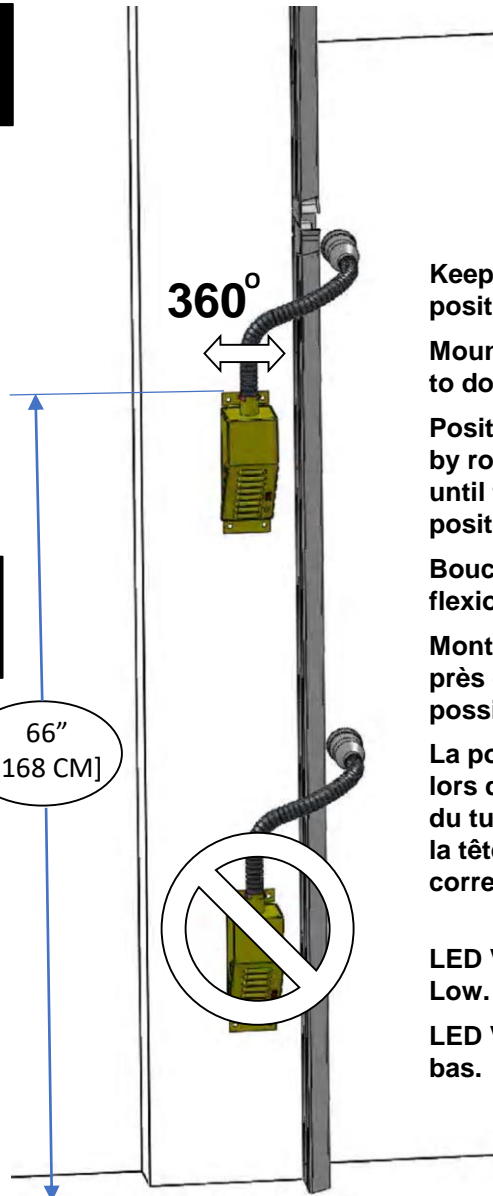

Keep flex tube in upward  
position.

Mount LED Versa Light as close  
to door track as possible.

Position the light head at install  
by rotating the tube at the base  
until the light head is properly  
positioned.

Bouchez le tube en position de  
flexion vers le haut.

Montez LED Versa Light aussi  
près du rail de la portière que  
possible.

La position de la tête d'éclairage  
lors de l'installation par rotation  
du tube à la base jusqu'à ce que  
la tête de la lampe est  
correctement positionné.

LED Versa Light mounted to  
Low.

LED Versa Light montée trop  
bas.



PATENTED

A Product of



Manufacturing

340 Gateway Park Drive  
North Syracuse, NY 13212

Phone: 315-463-7348

Toll Free: 866-235-7468

Fax: 315-463-8559

Email:

[info@dlmanufacturing.com](mailto:info@dlmanufacturing.com)

[www.dlmanufacturing.com](http://www.dlmanufacturing.com)

# DL Manufacturing

## **Terms / Conditions/ Warranty**

### Shipping Times

- ~ Orders for stock items received by 3:00pm EST will be processed for shipment the next day. Orders requesting 2<sup>nd</sup> Day Air or Overnight Air received by 1:00pm will be processed for same day shipment.

### Shipments / Freight

- ~ All DL Manufacturing orders will ship directly from our facility in North Syracuse, NY.
- ~ All parts will be shipped via FED EX unless you authorize a different service. UPS shipments are prepaid and the charges are added to your invoices.
- ~ For orders shipping by common carrier, the freight will be FOB, North Syracuse, NY. When “best way” is the preferred shipping method on your order, DL Manufacturing will choose the carrier, unless otherwise stated, for the orders shipping from this facility. No adjustments will be made after the order has shipped.

### Returns

- ~ DL Manufacturing will issue a Returned Material Authorization (RMA) number for any product, parts and accessories. Products returned without an RMA number will be refused.
- ~ Replacement parts will be invoiced at the time of shipping. Invoices will be credited upon receipt and inspection of Returned Material Authorization (RMA).
- ~ Freight for returns is paid for by the shipper unless otherwise specified by DL Manufacturing.
- ~ A restocking fee of 25% of net price or a minimum \$20.00 is charged for returns.
- ~ All replacement parts are warranted for a period of 90 days from shipment.
- Cancellation Fees
- ~ Cancellation charges may be incurred on orders cancelled with DL Manufacturing. Please contact DL Manufacturing to discuss each situation.

### **Warranty Policy**

~ All Products (excluding bulbs) manufactured by DL Manufacturing are warranted to be free from defects for a period of 12 months from the date of shipment, excluding doors, which have a warranty period of 12 months from date of installation or 18 months from shipment, whenever occurs first.

This warranty does not cover unreasonable/improper use or use beyond rated conditions, improper storage, negligence or accident; damage because of incorporated use of equipment with Goods, after Customer has or reasonably should have, knowledge of any defect; or improperly installed by any other Person that is unauthorized by DL Manufacturing.

This warranty is subject to customer covenants to inform all subsequent buyers of the Goods of the limitation on and exclusive of warranties provided for herein. Customer hereby indemnifies and agrees to hold DL Manufacturing harmless from and against all losses, costs and expenses, including reasonable attorney's fees incurred by DL Manufacturing as a result of any third party claim relating to the purchase, sale or use of, or otherwise relating to, the Goods covered by this Agreement.

In no event shall DL Manufacturing be required to repair, replace or reimburse Customer for more than the part or material that is found to be defective and DL Manufacturing's liability shall in such event be no greater than the invoiced price of the item and shall not include labor, shipping or other costs incurred in connection with the reshipment of defective Goods to DL Manufacturing or the reinstallation of such Goods after any repair or replacement. The remedy set forth in this paragraph is expressly agreed to be the sole and exclusive remedy for any breach of warranty. This warranty is exclusive and in lieu of all other warranties expressed or implied, including but not limited to any warranty of merchantability or of fitness for a particular purpose.

Limitation of Liability - In no event as a result of breach of contract, warranty or negligence shall DL Manufacturing be liable for special, or consequential damages including but not limited to loss of profits or revenues, loss of any equipment, cost of capital, cost of substitute equipment, facilities or services, downtime costs or claims of purchasers of the Customer for such damages. Additionally, DL Manufacturing will not be liable for any delay in the performance of contracts and orders, or in the shipment and delivery of goods, or for any damage suffered by the Customer by reason of delay, when such delay is, directly or indirectly, caused by force majeure, including war, Government interference, strikes, embargoes, shortage of labor, fuel, fires, floods, or any other cause or cause whether or not similar in nature to any of those herein before specified beyond DL Manufacturing's control.